

MFM Building Products Corp. manufactures a wide range of innovative waterproofing products for the building industry. Proven through many years of use in the field, MFM products are engineered for superior performance and ease of installation.

DESCRIPTION

SubSeal-40™ is a prefabricated self-adhering sheet-type waterproofing membrane. It is composed of a tough multi-layer cross laminated film that is coated with a rubberized asphalt adhesive. A release liner protects the adhesive and is removed as the membrane is installed.

SubSeal-40 is intended as a multi-purpose waterproofing membrane for use under siding and exterior plaster, as a through wall flashing, balcony decks, for foundation waterproofing and other below-grade structures or anywhere it will be protected from long-term UV exposure.

SubSeal-40 will adhere to many clean, dry substrates including metal, wood, rigid vinyl, masonry, G-P Densglass™, Gold Bond® e²XP™, rigid insulation boards and ICF foundations. Substrates may require priming with MFM Prime-A-Seal. Always prime masonry surfaces and wood composite panels (OSB). Allow primer to dry completely before applying SubSeal-40. Note: Test the adhesion of SubSeal-40 to substrates before starting the project and periodically as the job progresses.

The special SubSeal-40™ waterproofing adhesive has a broad temperature range for

improved adhesion in cool weather. This advanced system bonds to the substrate and self-seals around nails, staples and other fasteners to prevent damage caused by water penetration.

SPECIAL FEATURES

SubSeal-40™ offers the contractor and property owner these extra features:

- Uniform thickness for dependable protection.
- Self-seals around fasteners including nails, staples and screws.
- High strength, high elongation, flexible; accommodates expansion and contraction of the substrates.
- Protects ICF foundations and insulation boards from damage during backfill.
- Outer film surface is compatible with most construction sealants.
- Eliminates leaks—multiple layers of protection seal out water. Rubberized asphalt won't crack or dry.
- SubSeal-40™ adheres to most common building materials for ease of application and to eliminate movement of water under the membrane.

INTENDED USES

Foundation wall, through-wall, floor and planter waterproofing, under stucco and at head, sill, chimney shoulder, pot shelves, pony walls and parapets. Use for sealing SIPs building panels, Densglass and around window, doors and other potential leak areas.

SUBSEAL - 40™

Self-Adhering Waterproofing

INSTALLATION

- Apply in clear, dry weather. SubSeal is easily cut using sharp knife or scissors.
- Surface must be clean, dry and free from oil. Priming with Prima-A-Seal or approved primer is recommended for all surfaces.
- Masonry must be clean, fully cured and primed with an asphalt primer. Prime wood, OSB, metal, gypsum, weathered surfaces, Densglass, e²XP, and similar building panels.
- Use 3" side laps and 6" head laps.
- Apply uniform pressure with a 2"-3" hand roller to entire surface.
- **DO NOT** install over solvent-based sealants. Active solvents may liquefy bottom adhesive surface. MFM recommends using FutureFlash Sealant by Schnee-Morehead, Inc. Installer is responsible for assuring compatibility with caulks, sealants and primers.
- **DO NOT** install over flexible vinyl gaskets or uncured caulking.
- **DO NOT** expose installed product to direct sunlight for more than 180 days. If left exposed more than 7 days, apply approved sealant at all laps, seams and edges and tool flat. Maximum service temperature is 175°F.

Installation Range	>50°F
Color—material	Dark Gray
Roll Length	75ft
Roll Widths	4" 6" 9" 12" 18" 36"
Carton Weight	60lbs Nom.
Area / Carton	225 ft²

TEN YEAR LIMITED WARRANTY

MFM Building Products Corp. (MFM) warrants materials to be free from leaks caused by defects in material or manufacturing for a period of ten (10) years from the date of purchase when applied according to published directions and will, at its option, resupply or refund the purchase price of any materials proven to be defective. Misapplication or poor workmanship is specifically excluded under the terms of this warranty. MFM shall be liable for no additional remedies, hereby expressly denying any other claims for damages, whether direct or indirect, consequential or incidental, including but not limited to property damage, personal injury to the buyer or to a third party and loss of business or profit arising from the use or inability to use the product. Any implied warranties arising under state law are limited to the duration and terms of this express warranty.

PROPERTY	TEST METHOD	RESULTS
Thickness	ASTM D 1970	40 mils Nom.
Pliability @ 32°F	ICC-ES AC38	Pass
Water Vapor Transmission	ASTM E 96	0.02 g/m² in 24h Max.
Water Resistance	ASTM D 779	>30 Hr.
Nail Sealability	ASTM D 1970	Pass
Tensile MD	ASTM D 882	21 lbf/in
Tensile CMD	ASTM D 882	28 lbf/in

SubSeal -40™ meets the following requirements: ICC-ES AC 38. Approval ICC-ES ESR 2783



PARAPET OR GUARDWALL

MFM SUBSEAL 40

60 MIN. PAPER

2X FRAMING

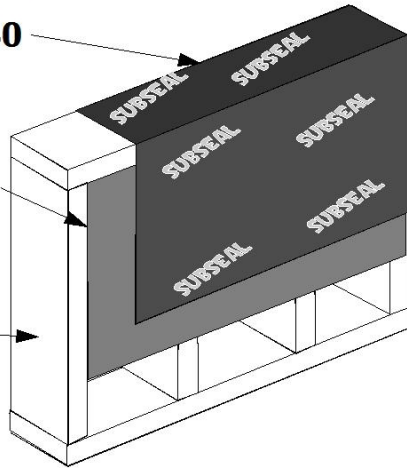

SUBSEAL 40 @ SHUTTER BACKING

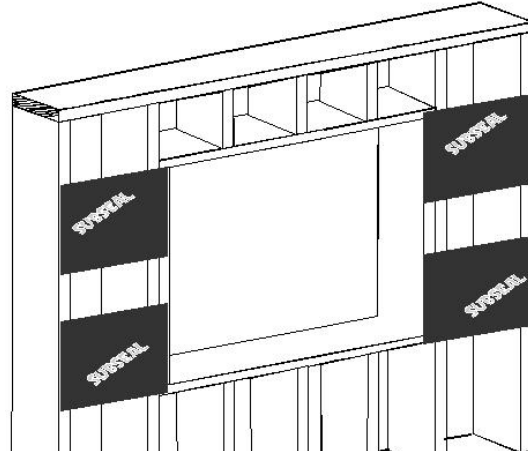

SUBSEAL 40 OVER DENSGLASS, OVER STEEL FRAMING.

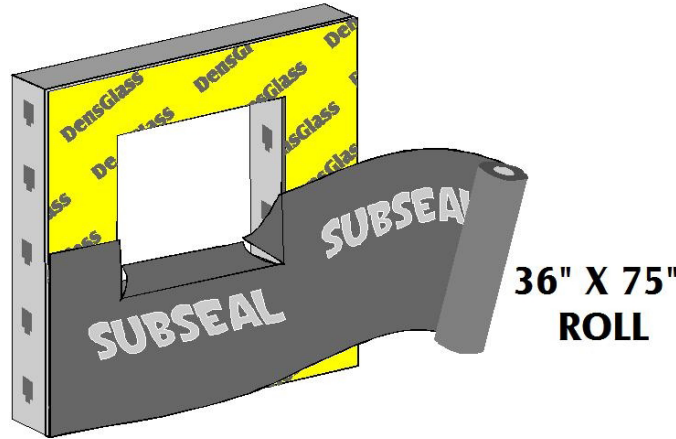

SUBSEAL 40 OVER WOOD FRAMED COLUMN

4\"X 4\" EXPOSED POST

26 GA. BONDERIZED METAL

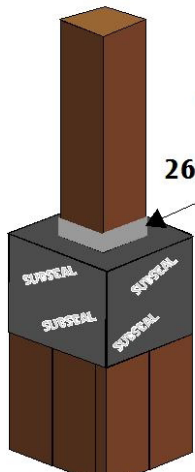

SUBSEAL 40 at Iron Rail attachment

12\" x 12\" SUBSEAL

3/8\" LAG @ IRON
RAIL MOUNT.

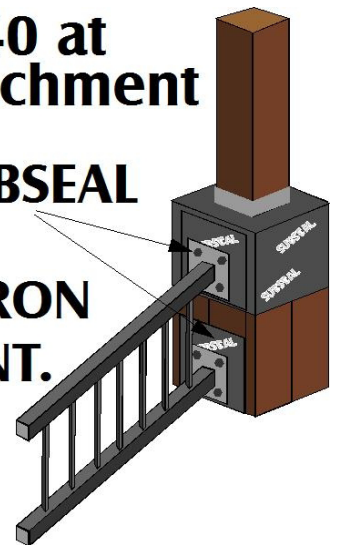

SubSeal™ Installation Information

DESCRIPTION

MFM SubSeal™ is a prefabricated self-adhering waterproofing membrane. A uniform thickness of rubberized adhesive asphalt is laminated to a durable, cross-linked, multi-layer polyethylene film providing an exceptional combination of strength and flexibility. Compared to spray-on waterproofing coatings, SubSeal provides a uniform layer of protection that is very durable, will not crack or dry out, and self-seals around mechanical penetrations.

USES

SubSeal is ideal for sealing foundation walls, exterior walls, through-wall flashings, around doors and windows, underneath stucco, tile, plaster and masonry, planters, pot shelves, and as a flashing material. It is ideal for application over Densglass exterior wall applications. While SubSeal may be used as a roofing underlayment, MFM recommends against this application because the slippery nature of the SubSeal film makes working on a roof hazardous. SubSeal may be used as a pipe wrap or protective covering for rigid insulation. SubSeal must be protected from long-term exposure to ultra-violet light. If left exposed more than 7 days, apply approved sealant at all laps, seams and edges and tool flat.

SURFACE PREPARATION

SubSeal-40 will adhere to many clean, dry substrates including metal, wood, rigid vinyl, masonry, G-P Densglass™, Gold Bond® e²XP™, rigid insulation boards and ICF foundations. Substrates may require priming with MFM Prime-A-Seal. Always prime masonry surfaces, wood composite panels (OSB) and Densglass. Allow primer to dry completely before applying SubSeal-40. Note: Test the adhesion of SubSeal-40 to substrates before starting the project and periodically as the job progresses. A primer helps to remove any surface dust or loose material that would inhibit good adhesion. For additional adhesion, especially in cool temperatures or on ICF foundations, use MFM Spray Adhesive.

INSTALLATION HINTS

- Apply only to clean, dry surfaces!
- Apply in clear, dry weather at recommended temperatures.
- Use 3" side laps and 6" head laps.
- Check compatibility with all sealants. Many sealants contain solvents or plasticizers that may attack & liquefy the asphalt adhesive when applied near or in contact with SubSeal. **It is the responsibility of the contractor to consult the sealant manufacturer to assure compatibility. MFM recommends FutureFlash Sealant™** manufactured by Schnee-Morehead, Inc. Do not encapsulate solvent-based materials or install over flexible vinyl gaskets.
- **Do not** expose installed product to direct sunlight for more than 180 days. If left exposed more than 7 days, apply approved sealant at all laps, seams and edges and tool flat. Maximum service temperature is 175°F.
- SubSeal is easily cut to shape with a sharp knife or scissors.
- Apply uniform pressure with a hand roller to the entire surface, paying particular attention to the seams. Always test adhesion of SubSeal to any surface and prime with MFM Prime-A-Seal as necessary to achieve a positive bond. MFM always recommends priming the substrate.

Recommended Temperatures		With MFM Spray Adhesive
Application Range	50°F to 105°F	Below 50°F
Installed Range	-20°F to 175°F	N/A